

**Product Features**

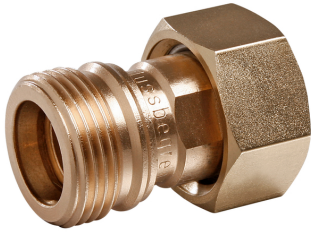

- wetted metal parts made from dezincification-free and corrosion-resistant gunmetal, resistant against aggressive water
- for pressure independent flow limitation
- inlet union nut, outlet male thread
- free from dead spots
- for any installation position

**Standards and Approvals**

- plastic parts with KTW and W 270 approval
- according to accepted materials list from German environmental agency
- ÜA-Reg.-Nr. R-15.2.3-21-17048, WIEN-ZERT

**Technical Data**

- pressure rating PN 16
- max. operating temperature 65 °C

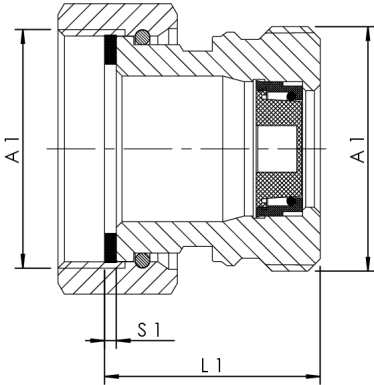

part no.	DN	A1	L1 (mm)	S1 (mm)	flow rate (l/min)	colour flow-restrictor	minimum flow pressure (MPa)	tolerance at max. flow pressure	kg
6970101500	15	G 3/4	37	2	2	dark grey	0,05	+/- 10 %	0,136
6970201500	15	G 3/4	37	2	10	blue	0,1	+/- 10 %	0,132
6970301500	15	G 3/4	37	2	20	green	0,1	+/- 10 %	0,13
6970102000	20	G 1	37	2	38	black	0,2	+/- 10 %	0,174
6970102500	25	G 1 1/4	37	2	70	blue	0,2	+/- 10 %	0,307
6970103200	32	G 1 1/2	38	2	110	white	0,2	+/- 20 %	0,397
6970104000	40	G 1 3/4	40	2	230	white	0,2	+/- 20 %	0,49
6970105000	50	G 2 3/8	48	3	350	white	0,2	+/- 20 %	0,845