

**Product Features**

- construction set version, suitable for the brick shell installation and for the subsequent installation in completed outer wall
- universal length for all common installation depths
- high discharge capacity of 40 l / min (1 bar)
- EPDM-seat gasket
- with socket wrench bonnet
- inlet male pipe thread
- matt chrome-plated operating handle with blue identification plate
- with aerator for automatic drainage
- can be extended with optional extension kit
- incl. hose coupling for common connection systems
- free from dead spots
- incl. torsion protection sleeve
- wetted metal parts made of dezincification-free and corrosion-resistant gunmetal (in closed position), resistant against aggressive water

**Standards and Approvals**

- WRAS approval

**Technical Data**

- min. installation depth 150 mm
- max. installation depth 415 mm
- pressure rating PN 10
- max. operating temperature 60 °C

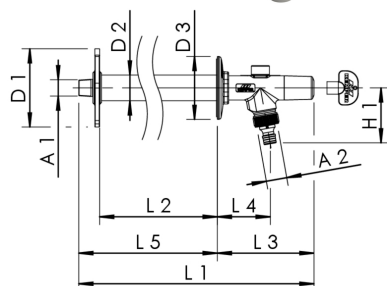

part no.	DN	A1	A2	D1 (mm)	D2 (mm)	D3 (mm)	H1 (mm)	L1 (mm)	L2 (mm)	L3 (mm)	L4 (mm)	L5 (mm)	flow at 0.05 Mpa (l/s)	flow at 0.1 MPa (l/s)	flow at 0.15 Mpa (l/s)
5741101500	15	R 1/2	G 3/4	100	33	80	70	563	415	123	67,5	440	0,4	0,67	0,8

part no.	kg
5741101500	1,857

**accessory**

- operating handle for FROSTI®, lockable, figure 575 00 003
- operating handle for FROSTI®, lockable and with master key system, figure 575 02 003
- extension for FROSTI®-PLUS, figure 574 00 002
- fixing set for FROSTI®-PLUS, figure 574 00 005
- dismantling key for lockable operating handle, figure 575 01 003
- sealing collar for FROSTI®, figure 574 00 006